

INSTALLING THINSULEX™ ABOVE RAFTERS

Ridge details

- Pack additional insulation tightly into ridge.
- Install Thinsulex™ over rafters and overlap ridge by 300mm on to opposite side of roof. Staple in place.
- Install Thinsulex™ on second side of roof and overlap ridge by 300mm. Batten in place.
- Ensure batten void is ventilated.

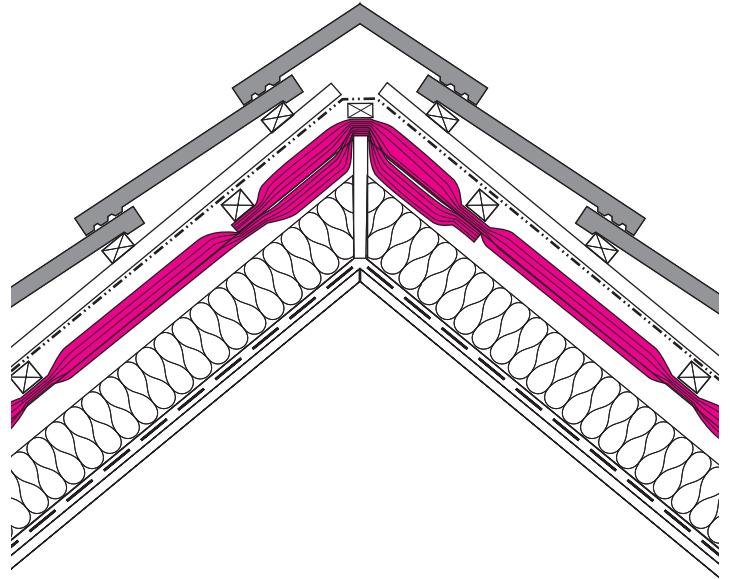

At junction of roof and wall

- Ensure batten void is ventilated
- Take additional insulation between rafters down to wall plate
- Take Thinsulex™ between rafters down to wall plate
- Pack insulation between fire barrier and Thinsulex

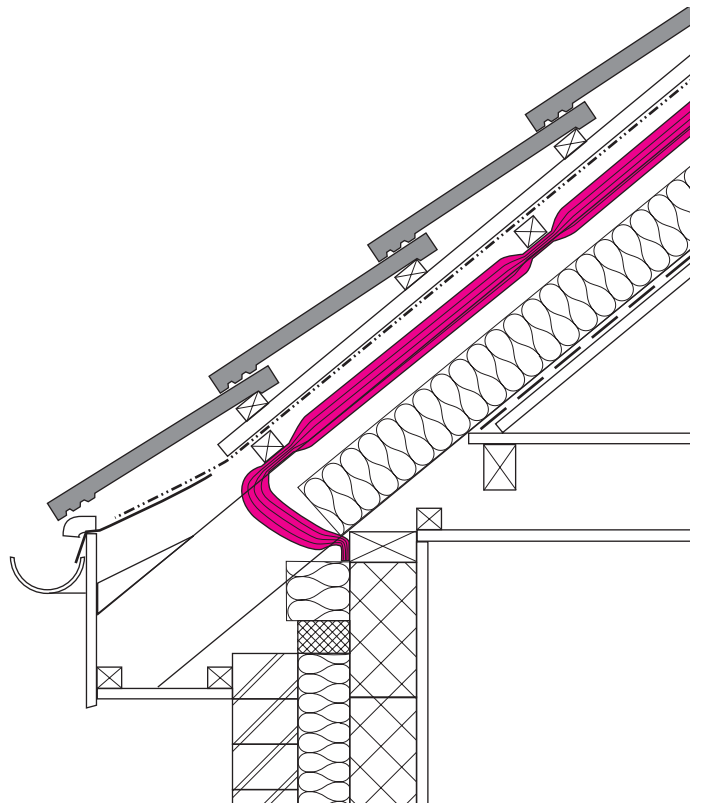

At junction of roof and gable

- Take cavity wall insulation level with top of gable wall
- Insert strip of insulation at top of gable to minimise air leakage
- Insert insulation between gable and end rafter
- Take Thinsulex™ past gable wall to prevent thermal bridging

