

category	seals
description	Xpandafoam sealing tape
part code	EXP...



XPANDAFOAM ACOUSTIC JOINT SEALING TAPES are self-adhesive, high quality, high density, open cell foam tapes, impregnated to a high level with acrylics and FR additives. The product is CFC- and HCFC-free and contains no chloride compounds.

Please Note: This product is for use as an acoustic expansion gap seal. It is not designed to be an intumescent expansion gap product. If you are looking for a fire rated acoustic intumescent product please speak to our technical department.

When the tape is compressed the foam cells close, thus offering a variety of sealing applications as detailed below:

- 20% compression – dust seal
- 50% compression – thermal seal
- 65% compression – draught/ acoustic seal
- 75% compression – acoustic/ protected weather seal – not directly exposed to water or UV
- 80% compression – acoustic/ weather seal to 600Pa – will resist water spray up to 600Pa differential to EN86

Product description

Xpandafoam is supplied pre-compressed for ease of application. All coils have a reinforced self-adhesive backing. When the rolls are opened the tape expands to five times its compressed thickness. The product is designed to accommodate movement in joints and seals against uneven surfaces

The elasticity and flexibility is perfect for sealing gaps between uneven surfaces such as brickwork and concrete. The tape maintains its elasticity and responds continually to expansion and contraction cycles without any joint failure. Tests to monitor the life expectancy reveal no significant deterioration over 20 years.

Applications

We recommend using Xpandafoam when installing our acoustic doors to give the maximum acoustic benefits. The 5mm gap between the structure and the frame must be sufficiently sealed to prevent noise leakage around the door. Using this product along with our fire rated flexible acoustic sealant (part code A250) will maintain the acoustic and fire integrity of the door assembly.

Xpandafoam can also be used around the perimeter of acoustic floors and acoustic ceilings, and is ideal for sealing gaps between pipes and services where they penetrate through a wall or floor.

Other applications:

- Structural concrete joints and pre-cast panel joints
- Sealing and finishing roofing and cladding panels and eaves
- Sealing door/window frames/roof lights
- Sealing pre-cast concrete guttering
- Sealing non-pressurised water/sewer pipes
- Sealing roofs/panels/window frames/doorframes in van/campers/caravans, portable/modular buildings or mobile offices
- Sealing plastic corrugated plastic panels, metal roofing and wall sheets
- Sealing partitions and interior or exterior panels
- Anti-corrosion joints for metal to metal fixtures
- Perimeter sealing of conservatory systems between brickwork and plate
- Sealant backer and expansion joints
- Wood construction – log homes and cabins

Installation Guidelines

IMPORTANT: Should material expand in the package it can still be used. Unroll the material, allow it to expand, then recompress it between surfaces to be sealed.

1. Storage – Store in a warm, dry interior location, keep flat and compact. Ideal application temperature is approx. 24°C. Expansion is faster at higher temperatures and slower at lower temperatures. Full expansion normally takes about 24hrs from when the material is first opened but when re-compressed it will re-expand within minutes. For faster expansion in cold conditions keep the material warm before use and, if desired, apply heat from a hair dryer to **installed** material to accelerate expansion.

2. Surface Preparation – Joint faces should be dry and cleaned of dirt, oil and grease etc. There should be sufficient depth to receive the full width of the tape.

3. Opening reels – Only open rolls for immediate use.

4. Square off ends – Start and finish ends must be cut square. For easier cutting spray the knife or scissors with a mist of water.

5. Peel off liner A suitable length should be cut to fit the opening. The material only expands in one direction i.e. its thickness not its width. For acoustic purposes we recommend that it not be allowed to expand more than 35% of its fully expanded thickness so its important to check the gap size before

ordering/using the material. For larger gaps two layers can be stuck one on top of the other. Remove release liner to expose the adhesive backing face of the tape.

5. Attach to surfaces Position the tape and press firmly to secure. If needed, cut and fit smaller filler pieces of tape to fill panel or corrugation voids.

7. Join lengths with mitres To form a continuous strip, overlap tapes at join and cut/mitre with a damp knife at a 45° angle. Pinch the mitred faces together.

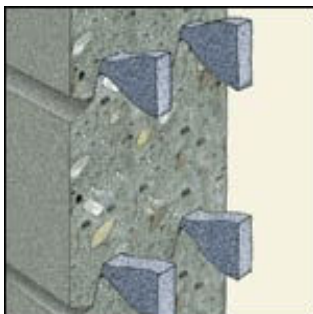
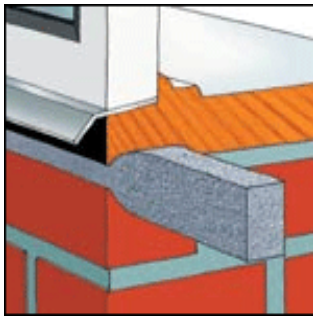

Technical Specification

Product	XpandaFoam Tape
Foam	Polyurethane with impregnation
Adhesive	Acrylic dispersion
Colour	Grey (or black subject to MOQ)
Thickness	Pre-compressed rolls, one side self-adhesive. Length of roll: 2-12m depending on thickness. Thickness: 10-150mm (decompressed) Widths: 10-1000mm
Tensile strength DIN 53 57 1	At least 100 kPa
Tensile elongation DIN 53 57 1	At least 200%
Compressive strength at a compression of +40°C DIN 53 57 7	oa.3,4 kPa (± 15%)
Behaviour under fire DIN 4102-1	B1 (P-NDSO4-284)
Temperature resistance	-30°C until +100°C +130°C for short time
Water tightness under heavy rain wind force: 11/height of building: 100m DIN EN 1027 (DIN EN 86)	>600 Pa/stress group B1 (wind force: 11/height of building: 100m)
Sound absorption	R' _{st,w} :48dB
Weathering resistance	> 10 years
Thermal conductivity	0.07 W/mK
Permeability of joints DIN EN 1026 (DIN EN 42)	coefficient of joint permeability a<0,1 m ³ .hm (daPa)n
Density	90-110kg/m ³

Tape Type	Full Expansion	Coil Length
EXP2/3	expands to 10mm	12.5m
EXP3/4	expands to 15mm	10m
EXP3/7	expands to 20mm	8m
EXP5/8	expands to 25mm	6.6m
EXP5/10	expands to 30mm	5.6m
EXP7/12	expands to 40mm	4.3m
EXP10/16	expands to 50mm	3.3m
EXP12/20	expands to 60mm	2.6m
EXP16/26	expands to 80mm	4m
EXP20/30	expands to 100mm	3m
EXP24/40	expands to 120mm	2.6m