

## Soundproofing Solutions to Meet New Part E Building Regulations

### TYPE 2.7

#### Separating Wall / Timber Stud / 48 R<sub>w</sub>dB +C<sub>tr</sub> Application

Sound Reduction Performance	
55 R <sub>w</sub> dB	48 R <sub>w</sub> dB+C <sub>tr</sub>
Part E Acoustic Requirement	
New Build 45 D <sub>nTw</sub> +C <sub>tr</sub> dB	Refurbishment 43 D <sub>nTw</sub> +C <sub>tr</sub> dB

#### Components and Fixing Data:

- 1 x 12.5mm Acoustic Plasterboard (offset and screwed to)
- 1 x 15mm Acoustic Plasterboard (offset and screwed to)
- 75mm x 50mm Timber Studs (at 600mm centres)
- 52mm Acoustic Quilt (suspended in cavity between studs)
- 1 x 12.5mm Acoustic Plasterboard (screwed to)
- 15mm Acoustic Plasterboard (screwed through)

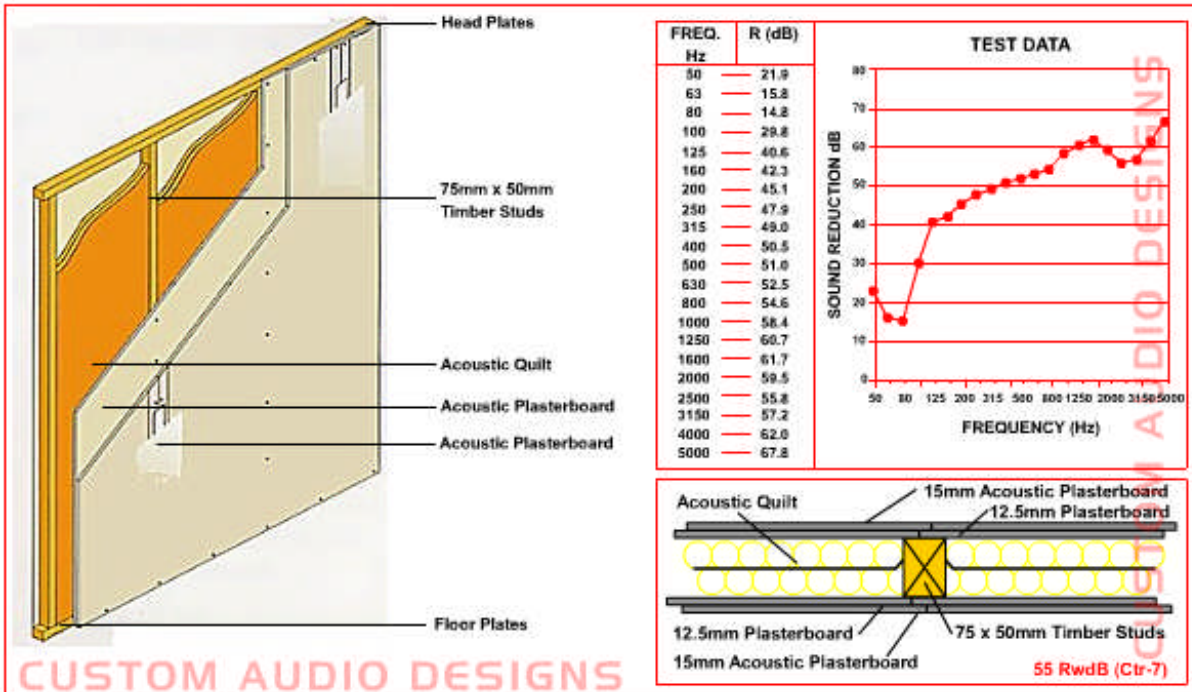

#### Technical Data:

Mass per Unit Area:	55Kg/m <sup>2</sup>
Footprint Width:	130mm
Fire Protection:	60 Minutes